

*Calling all aspiring tree planters! We need you!*

## Reforestation of The Palmer Property in Barrow Bay May 26, 27, 28

**LAURA PISKO**  
DIRECTOR OF CONSERVATION  
& LAND STEWARDSHIP

The Peninsula Bruce Trail Club is thrilled to announce Bruce Trail Conservancy (BTC) approval for the restoration of the old Palmer property. This 5.6-acre property is located west of the village of Barrow Bay on Bruce Road 9. It consists mainly of a meadow with apple and hawthorn trees due to extensive logging of its woodlands in the late 1800s and the 1900s.

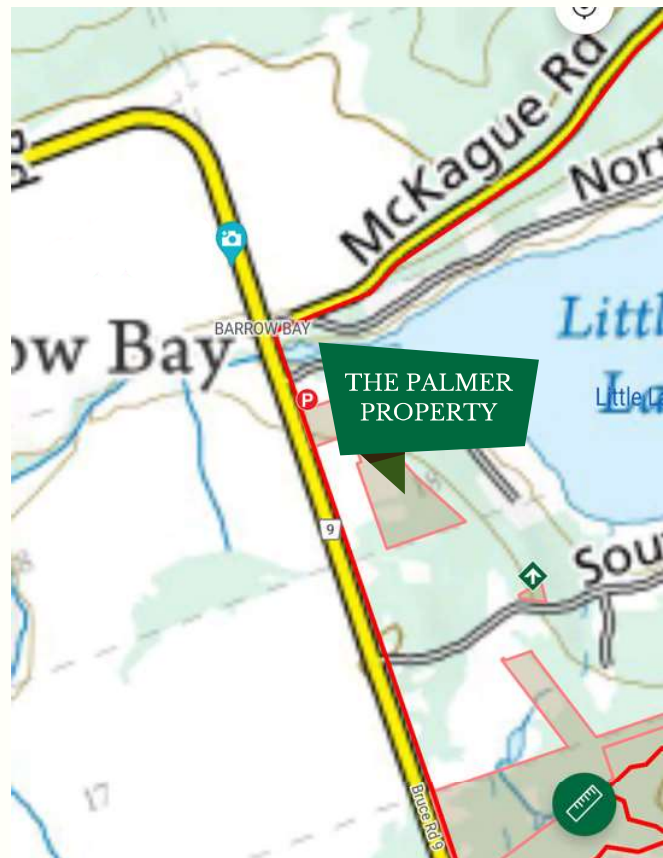

MAP OF THE PALMER PROPERTY

The property's woodland habitat will be revitalized by planting over 600 native fruit and nut bearing trees and shrubs (all small saplings). Over a dozen species of native plants will add valuable biodiversity to provide sustenance and shelter to many species of birds, wildlife and pollinators found on the peninsula. The fruit and nut bearing trees and shrubs include red oak, hickory, elderberry, serviceberry, chokecherry and winterberry.

Some of the trees are being donated by Tom Gehrels, a local travel agent with Adventure Coordinators. He hopes to help address climate change through carbon sequestration by the trees. In general, carbon sequestration will be provided in greater amounts each year until the trees and shrubs reach maturity.